

Technical data sheet

Junction box X 16 with hat profile rail

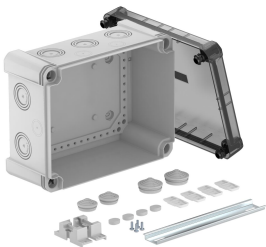







Item number: 2005100

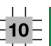

Junction box with hat profile rail for the connection of cables and lines indoors and in outdoor areas. Rectangular design with knock-out entries. Suitable for wall and ceiling mounting with the option to fasten outside, inside or to mount via the corner domes. Particularly impact resistant with IK09. Transparent cover with quick lock, sealable. Made from halogen-free and UV-resistant materials.

With hat profile rail type 2069.

Junction box according to DIN EN 60670. Flame-resistant to DIN EN 60695/2/11, test temperature 650 °C. Impact resistance IK09 according to DIN EN 50102. Protection rating IP67 according to DIN EN 60529. With transparent cover and hat profile rail, type 2069, with fastening set.



PC

Polycarbonate

| Master data | | |
|-----------------------------------|---------------------------|--|
| Item number | 2005100 | |
| Description 1 | Junction box | |
| Description 2 | with tans. lid, rail 2069 | |
| Manufacturer | OBO | |
| Dimension | 240x191x125 | |
| Colour | Grey / transparent | |
| Material | Polycarbonate | |
| Smallest sales unit | 1 | |
| Unit of quantity | Piece | |
| Weight | 87.3 kg | |
| Weight unit | kg/100 pc. | |
| CO Footprint (GWP) Cradle-to-Gate | 4,5419 kg COe / 1 Piece | |

Technical data sheet

Junction box X 16 with hat profile rail

Item number: 2005100



Dimensions

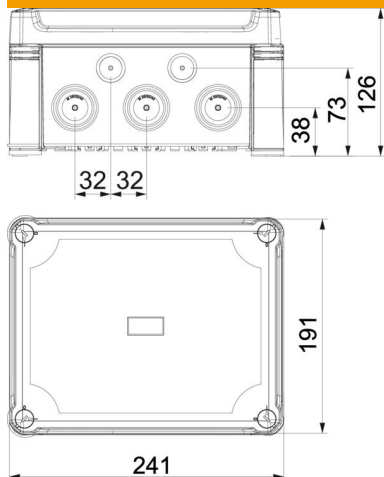

| | |
|--------|--------|
| Length | 241 mm |
| Width | 191 mm |
| Height | 126 mm |

Technical data

| | |
|-----------------------------------|---|
| Expandable | yes |
| No. of entries | 10 |
| Type of entry | Cuttable stepped membrane |
| Type of housing penetration | Pre-marking |
| Measured insulation voltage V_i | 750 V |
| Equipment | Support rail |
| Cover | Not transparent |
| Cover fastening | Screwed |
| Entry from rear | no |
| Entries | 10 x Ø25/32/40 |
| Explosion-tested version | no |
| Flame-resistant | acc. to VDE 0471/DIN 695 Part 2-1, test temperature 650°C |
| Shape | Rectangular |
| Fibre-glass reinforced | yes |
| Halogen-free | yes |
| Clear internal dimensions | 227x177x110 mm |
| Max. Conductor cross-section | 16 mm ² |
| With screening | no |
| with lid | yes |
| Mounting type | Wall/ceiling mounting |
| Nominal cross-section, max. | 16 mm ² |
| Nominal cross-section, min. | 6 mm ² |
| Nominal voltage | 750 V |
| Sealable | yes |
| Impact-resistant | yes |
| Protection rating | IP67 |
| Protection rating IK code | IK09 |
| Permitted temperature range, max. | 60 °C |
| Permitted temperature range, min. | -5 °C |
| Weatherproof | yes |